

**2201161 RV3-ST-24V**

**2201160 RV3-ST-12 V**

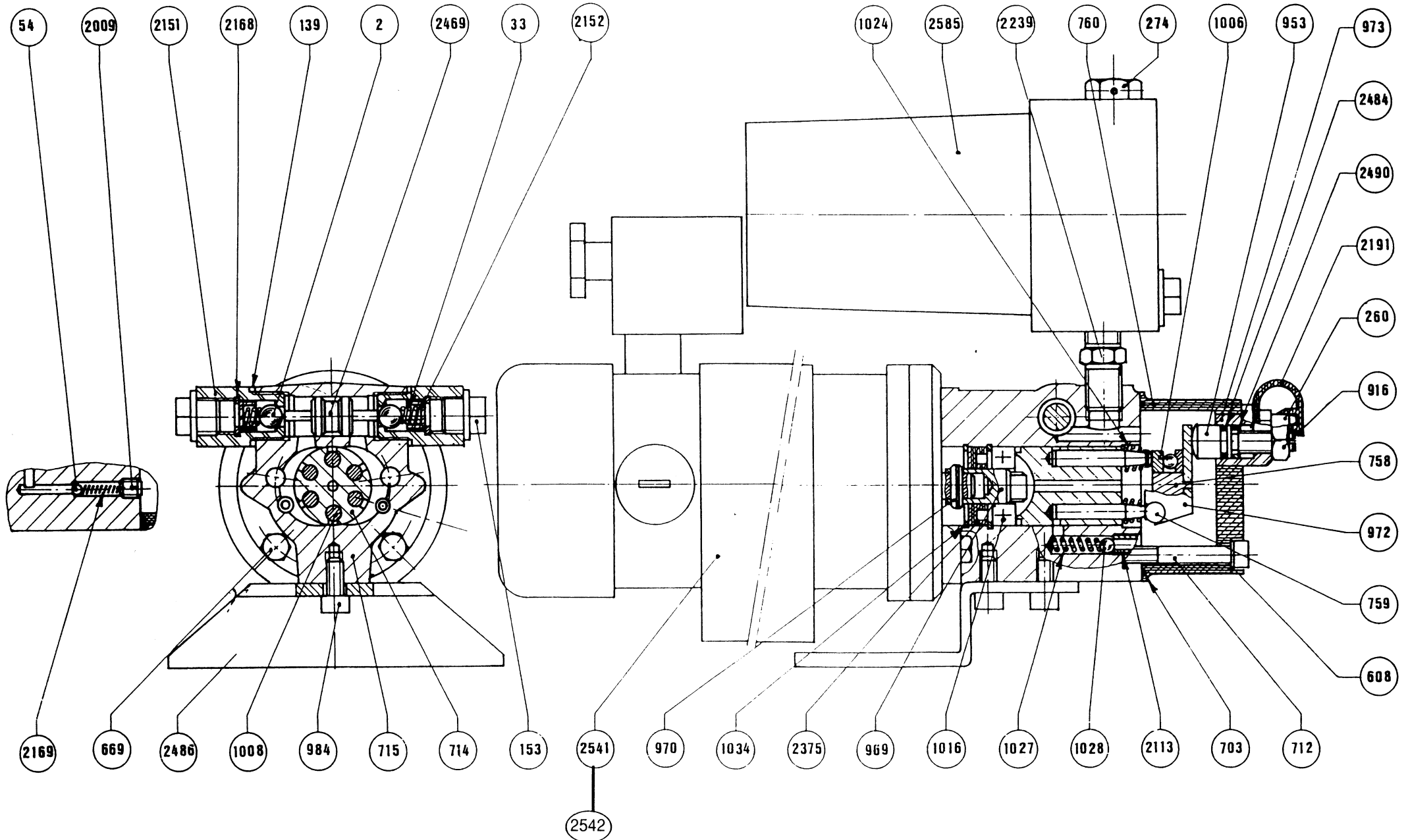

<u>REP.</u>	<u>NBR</u>	<u>CODE</u>	<u>DÉSIGNATION</u>	
2	2	1200002	BILLE 9 ZT	BALL 9 ZT
33	2	1200033	RESSORT 5X6X10,5	SPRING 5X6X10.5
54	2	1200054	BILLE 4 ZT	BALL 4 ZT
139	2	1200139	JOINT PLAT G 3/8 A	FLAT SEAL G 3/8 A
153	3	1200153	BOUCHON STOCKAGE M.G 1/4	STORAGE PLUG M. G 1/4
260	1	1200260	PURGEUR VHM	VHM BLEEDER
274	1	2200274	BOUCHON CLAPET G 1/4	VALVE PLUG G 1/4
608	3	1100608	JOINT PLAT6X10X1 FIBRE	FLAT SEAL 6X10X1 FIBER
703	1	1200703	JOINT OR 56,87X1,78 N-70	O-RING 56.87X1.78 N-70
712	3	1200712	VIS CHC M6X45 A2	SCREW CHC M6X45 A2
714	1	1200714	BARILLET RV2	BARREL RV2
715	1	1200715	CORPS RV2	BODY RV2
758	1	1200758	CENTREUR RV2	CENTER PUNCH RV2
759	2	1200759	AXE ARTICULATION RV2	HINGE PIN RV2
760	1	1200760	CARTER RV2	HOUSING RV2
916	1	1200916	ECROU HM M8 A2	NUT HM M8 A2
953	1	1200953	VIS REGLAGE DEBIT RV2	ADJUSTING SCREW RV2
969	1	1200969	ARBRE RV2	SHAFT RV2
970	1	1200970	GOUPILLE ELASTIQUE SPIRALE 4X16 MBK	SPIRAL SPRING PIN 4X16 MBK
972	1	1200972	BASCULEUR RV2	TIPPER PLATE RV2
973	1	1200973	ADAPTEUR RV2	ADAPTER RV2
984	2	1200984	VIS CHC M6X16X A2	SCREW CHC M6X16XA2
1006	1	1501006	BUTEE BILLES 51200	THRUST BALL BEARING 51200
1008	6	1501008	PISTON 66	PISTON 66
1016	1	1501016	ROULEMENT 6001	BALL BEARING 6001
1024	6	1501024	RESSORT PISTON 66	PISTON SPRING 66
1027	2	1501027	RESSORT 3,8X4,8X18,5	SPRING 3.8X4.8X18.5
1028	2	1501028	BILLE 5 ZT	BALL 5 ZT
1034	2	1501034	ANNEAU ELASTIQUE POUR ALESAGE 28X1,2	FLEXIBLE RING FOR 28X1.2 BORE
2009	2	1202009	VIS CLAPET SURPRESSION RV2	SCREW FOR PRESSURE RELIEF VALVE RV2
2113	2	1202113	VIS CLAPET ASPIRATION RV2	SCREW FOR SUCTION VALVE RV2
2151	2	1202151	SIEGE CAR RV2	LOCK VALVE SEAT RV2
2152	2	1202152	BUTEE RV2	STOP RV2
2167	4	1202167	VIS H M5X16 8.8	SCREW H M5X16 8.8
2168	2	1202168	ANNEAU ELASTIQUE POUR ALESAGE 12X1	FLEXIBLE RING FOR 12X1 BORE
2169	2	1202169	RESSORT 3X4,6X20	SPRING 3X4.6X20
2191	1	1202191	PROTECTION PURGEUR VHM	BLEEDER PROTECTION VHM
2239	1	1202239	MAMELON 2XG1/4 M-LAITON-N	NIPPLE 2XG1/4 M BRASS N
2375	1	1202375	JOINT LEVRES RENF. 12X28X7 N85	LIP SEAL REINF. 2X28X7 N85
2469	1	1202469	TIROIR RV2-ST	SLIDE RV2-ST
2484	1	1202484	JOINT OR 7 N-70	O-RING 7 N-70
2486	1	1202486	PATTE RV3	LUG RV3
2541	1	1202541	MOTEUR RV3 12VCC EQUIPE	EQUIPPED MOTOR RV3 12 VCC
2542	1	1202542	MOTEUR RV3 24 VCC EQUIPE	EQUIPPED MOTOR RV3 24 VCC
2585	1	1202585	RESERVE RV2-ST	RESERVE RV2-ST

<u>CODE</u>	<u>DÉSIGNATION SOUS-ENSEMBLE</u>	<u>DESIGNATION OF SUB-ASSEMBLY</u>
1200656	POCHETTE JOINTS RV2	SEAL KIT RV2
1202766	JEU CHARBONS BC 220	SET OF CARBON BRUSHES